

Toko Standard PCB

(Reference only)

Toko P/No. : TDFM2A-3549T-10A

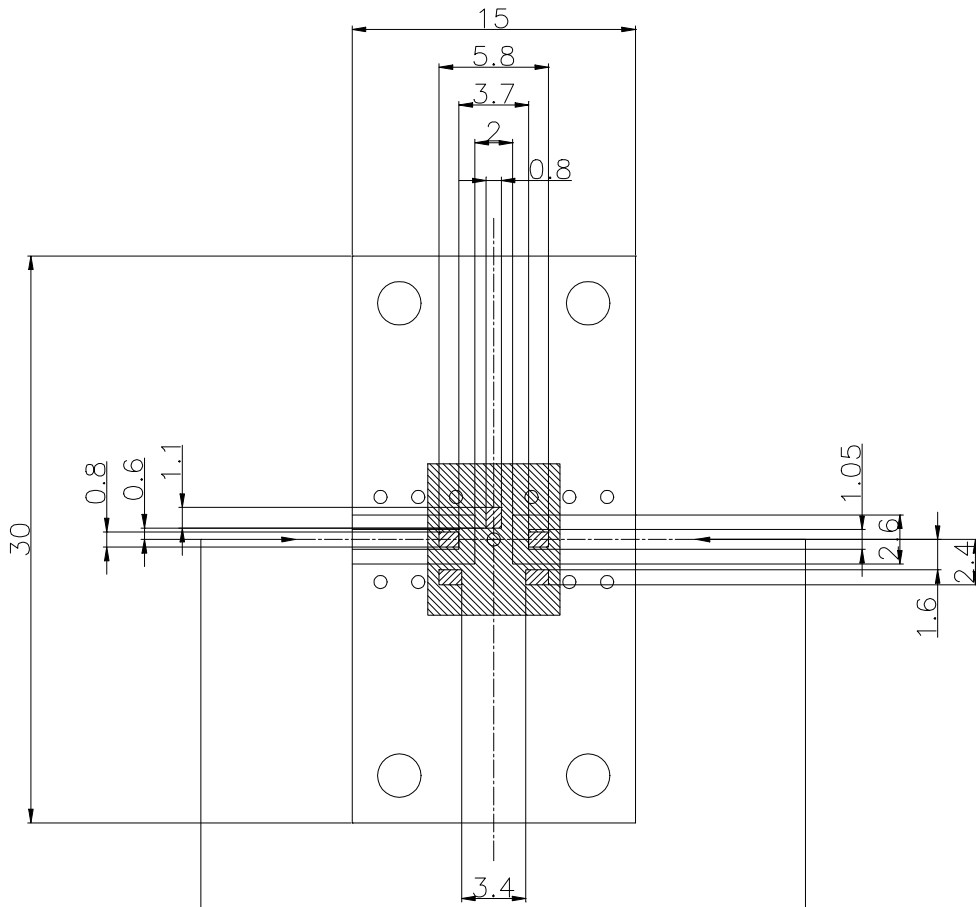

Impedance of signal lines should be 50Ω including land pattern.

-  Soldering Parts
-  Solder Resist

Back plane is all coppered.
All holes are plated-through hole.

Substrate Material:

BT Resin CCL-H870 $t=0.4\text{mm}$.

CCL-H870's typical dielectric constant is 3.6 at 1GHz.